

SALES DRAWING SALES DRAWING

SALES DRAWING SALES DRAWING

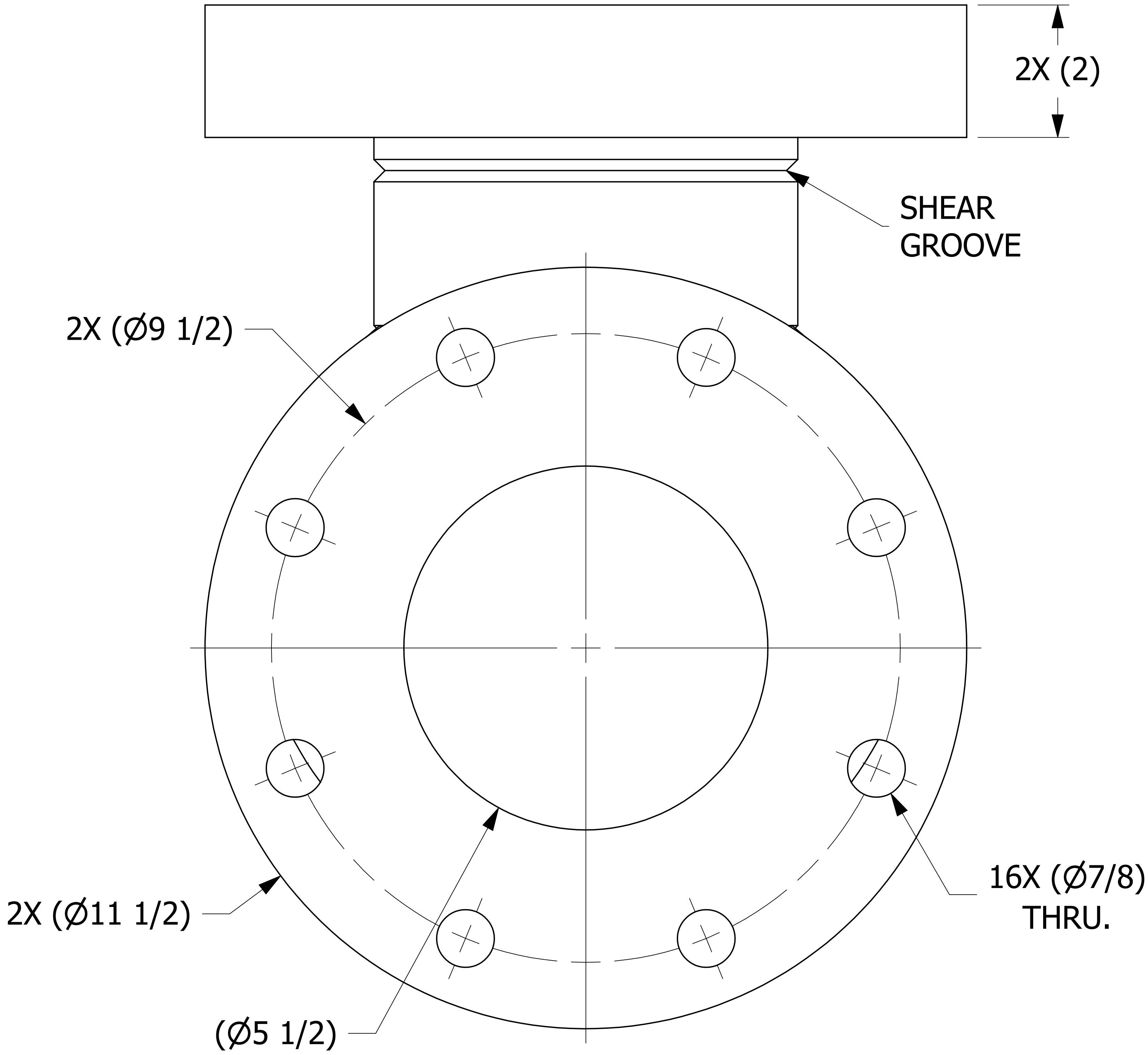

(9 23/32)

(8 7/8)

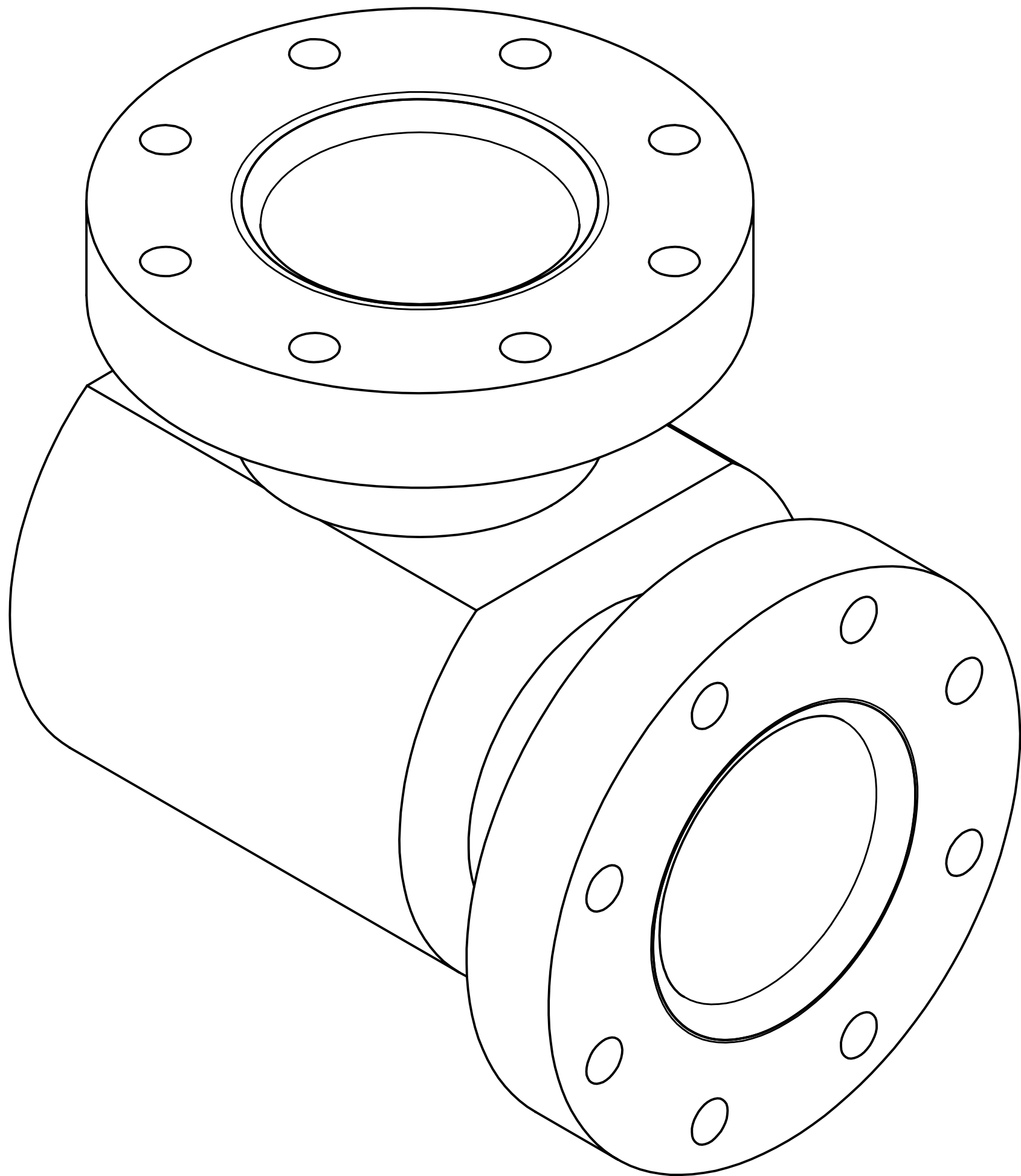

ISOMETRIC VIEW

NOTE:
SOLD TO WORLEY WELDING ONLY.

F	GS	2-13-13	UPDATED TITLE BLOCK
E	GDS	8-1-11	ADDED MARKING PRESSURE NOTE
D	REH	12-1-10	HOLE DIAMETER INCREASED TO .88
C	VD	09-09-10	REPLACED HS1112FL W/ HS6FLGS. REV. NOTES.
B	CHL	1-18-10	REPLACED HS6DTFL W/HS1112FL
A	PJG	9-28-09	NEW PART ADDED TO SYSTEM
REV	BY	DATE	DESCRIPTION

UNLESS OTHERWISE SPECIFIED DIMENSIONAL TOLERANCES FRACTIONAL: ±1/16 X.XX: ±.03 X.XXX: ±.015 ANGULAR: ±1° DEBURR ALL SHARP EDGES. ALL MACHINED SURFACES TO HAVE A 125 RMS FINISH UNLESS NOTED OTHERWISE. THIRD ANGLE PROJECTION	DRAWN BY:	CHL
	CHECKED BY:	PJG
	PROTOTYPE BY:	CHL
	PROTOTYPE DATE:	5/13/2009
	APPROVED FOR PRODUCTION BY:	PJG
	PRODUCTION DATE:	9/28/2009

PART NAME: ELBOW 6"X90°		
MATERIAL: SALCO PE		
PROJECT #: 090428	SHEET #: 1 OF 1	SCALE: 1:1
DRAWING #: E26856	PART #: HS6X90PE1	